

DRAWING NUMBER
R6121-02 —
R6129-02



THIRD ANGLE PROJECTION

DO NOT SCALE

OBSOLETE

THREAD M 2.5x0.45-6H

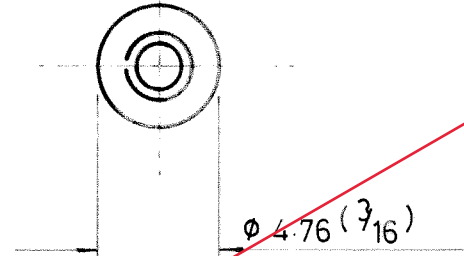
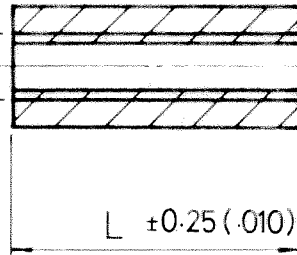

NOTE

1 THD. TO BE MANU. IN ACCORDANCE WITH
BS 3643 pt. 2 : 1966

	R6129-02		20	.787
	R6128-02		18	.708
R101993C	R6127-02		16	.630
R101992C	R6126-02		14	.551
R101851C	R6125-02		12	.472
R101857C	R6124-02		10	.394
	R6123-02		8	.315
R101979C	R6122-02		6	.236
R101854C	R6121-02		4	.157
	PART NO	DRG NO	mm.	ins.
			L ±0.25 (.010)	

11	5-3-79	FINISH WAS DTD 9.9
10	31-10-78	WAS MA1476 TO MA1484
1	3-6-75	
ISS.	DATE	CHANGE
APPD.	<i>SLB</i>	
CHKD.	<i>R. Driscoll</i>	
DRAWN	<i>Markus Ross</i>	
OLD REF.	R 6021/1 - 6029/1	
ASSY. DRAWING		

HARWIN ENGINEERS S.A.
PORTSMOUTH PO6 IRT

MATERIAL BRASS BS249

FINISH NICKEL PLATE

TITLE

THREADED SPACER - ROUND

TOLERANCES

FRAC. ± 1/64 DEC ± .005 MM ± .13

DIMS. IN MM (INS) SCALE —

DRAWING NUMBER

R6121-02

R6129-02