

DRAWING NUMBER  
 R4444-02 —  
 R4446-02



THIRD ANGLE PROJECTION

DO NOT SCALE

$\phi$  4.08<sup>+08</sup>-<sup>-00</sup> (.160<sup>+003</sup>-<sup>-000</sup>)  $\phi$  0.08  
 $\phi$  4.78<sup>+00</sup>-<sup>-08</sup> (.188<sup>+000</sup>-<sup>-003</sup>)

NOTE  
 THD. M4x0.70-6H TO BE MANU. IN  
 ACCORDANCE WITH BS 3643 pt 2 : 1966

**OBSOLETE**

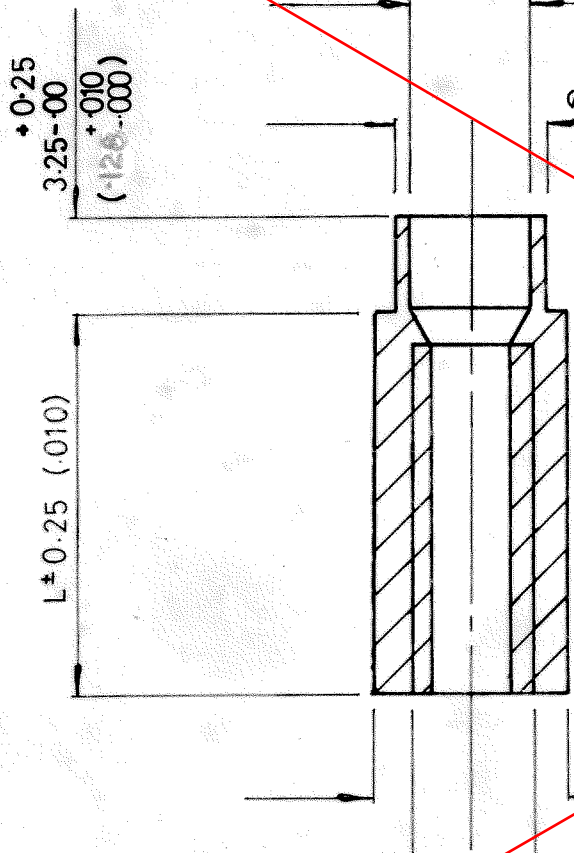

THREAD M4x0.70-6H  
 SEE NOTE.

R4446-02	519.047	12	.472
R4445-02	454.017	10	.394
R4444-02	323.957	6	.236
PART N <sup>o</sup>	<u>S. area</u>	mm	ins
		L ± 0.25 (.010)	

12	15.4.91	1816
11	5.3.79	FINISH WAS DTD 8/79
10	31.10.78	WAS MA1460 - MA1462
2	28.2.78	409
1	4.6.75	
ISS.	DATE	CHANGE
APPD.	<i>fb</i>	
CHKD.	<i>R. Discoll</i>	
DRAWN	<i>Nolan</i>	
OLD	REF.	
R4044	5/6	
ASSY.	DRAWING	

**HARWIN ENGINEERS S.A.**  
 PORTSMOUTH PO6 1RT

MATERIAL BRASS BS2874 CZ121  
 TITLE CAPTIVE SPACER-THREADED

FINISH NICKEL PLATE F0203  
 TOLERANCES  
 FRAC. ± 1/64 DEC ± .005 MM ± .13  
 DIMS. IN MM (INS) SCALE —

DRAWING NUMBER  
 R4444-02 —  
 R4446-02