

# Customer Information Sheet

DRAWING No.: M20-890XX05      SHEET 2 OF 2      IF IN DOUBT - ASK      ©      NOT TO SCALE      THIRD ANGLE PROJECTION      ALL DIMENSIONS IN mm

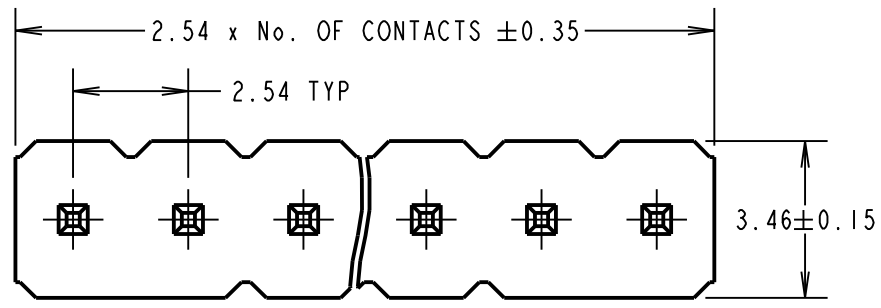

- NOTES:
1. CO-PLANARITY: FLATNESS OF SMT TAILS TO MOULDING DOES NOT EXCEED 0.20mm.
  2. ALL TOLERANCES ARE ±0.25, UNLESS OTHERWISE STATED.

**OBSELETE**  
 No. of Contacts:  
 21 to 25

SPECIFICATION:

MATERIAL:  
 MOULDING = NYLON 6T UL94V-0, BLACK  
 CONTACT = BRASS

FINISH:  
 CONTACT = GOLD FLASH OVER NICKEL

ELECTRICAL:  
 CURRENT RATING = 3A  
 CONTACT RESISTANCE = 20mΩ MAX  
 INSULATION RESISTANCE = 1000MΩ MIN  
 DIELECTRIC STRENGTH = 1000V AC FOR ONE MIN

ENVIRONMENTAL:  
 TEMPERATURE RANGE = -40°C TO +105°C  
 FOR COMPLETE SPECIFICATION, SEE COMPONENT SPECIFICATION C001XX (LATEST ISSUE).

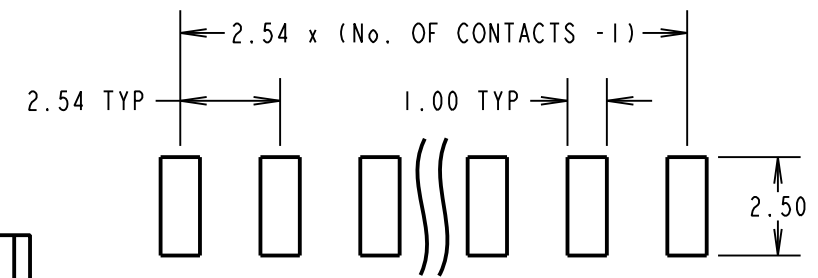
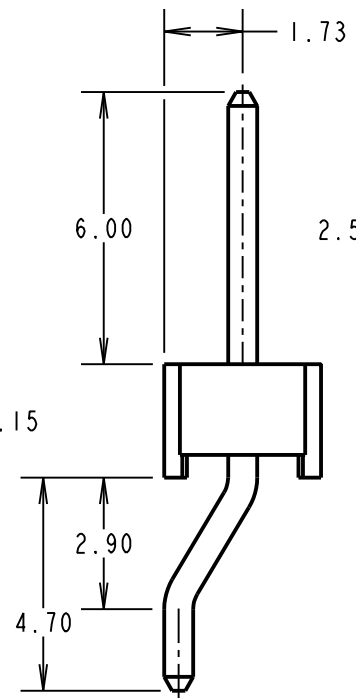
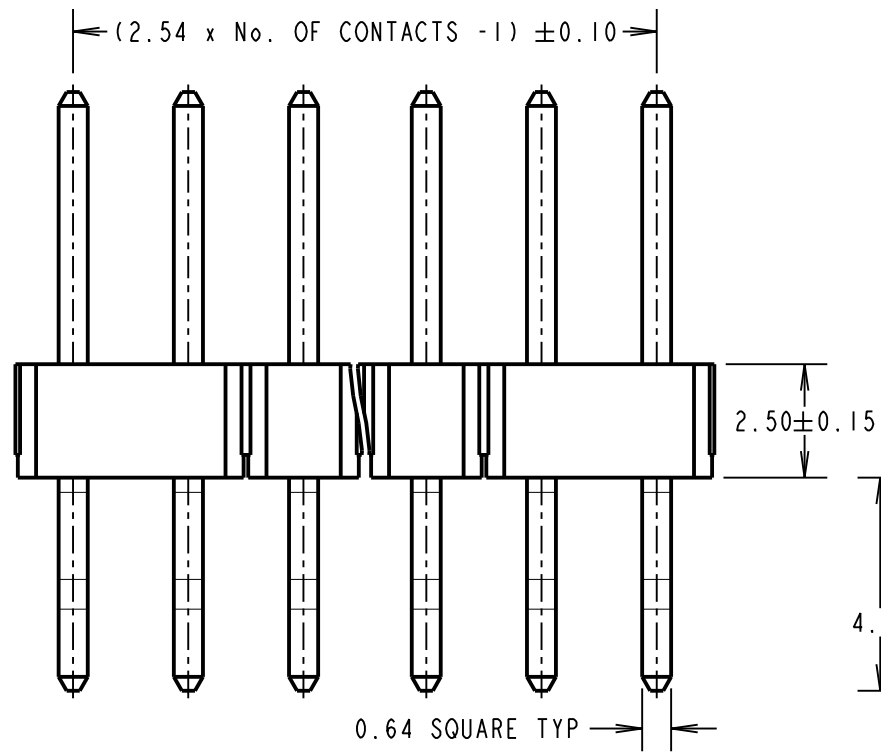

RECOMMENDED PAD LAYOUT  
 (TOLERANCE = ±0.05)

ORDER CODE:

**M20-890XX05**

No. OF CONTACTS: \_\_\_\_\_  
 03 TO 25

|                    |      |          |        |
|--------------------|------|----------|--------|
| MSP                | 5    | 24.06.16 | 13387  |
| NAME               | ISS. | DATE     | C/NOTE |
| APPROVED: M.PERREN |      |          |        |
| CHECKED: S.BENNETT |      |          |        |
| DRAWN: S.BENNETT   |      |          |        |
| CUSTOMER REF.:     |      |          |        |
| ASSEMBLY DRG:      |      |          |        |



www.harwin.com  
 technical@harwin.com

THIS DRAWING AND ANY INFORMATION OR DESCRIPTIVE MATTER SET OUT HEREON ARE CONFIDENTIAL AND COPYRIGHT PROPERTY OF THE HARWIN GROUP AND MUST NOT BE DISCLOSED, LOANED, COPIED OR USED FOR MANUFACTURING, TENDERING OR FOR ANY OTHER PURPOSE WITHOUT THEIR WRITTEN PERMISSION.

~~TOLERANCES~~

mm  
 X.X = ±0.50mm  
 X.XX = ±0.10mm  
 X.XXX = ±0.01mm

ANGLES = ±5°  
 UNLESS STATED

MATERIAL:  
 SEE ABOVE

FINISH:  
 SEE ABOVE

S/AREA:  
 mm<sup>2</sup>

TITLE:  
 2.54mm PITCH SIL HORIZONTAL SMT PIN HEADER ASSEMBLY

DRAWING NUMBER:  
**M20-890XX05**

SHT  
 2 OF 2