

# Datamate J-Tek 3-Row Connectors

DATAMATE J-TEK 3-RROW

## Male Vertical Throughboard

- Board Mount nuts to be tightened to a maximum torque of 23cmN.
- Fully shrouded contacts.
- Polarized housings.
- All contacts are gold finish for full RoHS compliance.
- Mates with all Datamate 3-Row female connectors with compatible jackscrews.

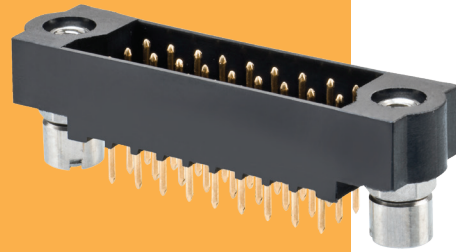

### MALE VERTICAL

### CALCULATION

<b>A</b>	B + 15
<b>B</b>	(Total no. of contacts - 3) x 2/3
<b>C</b>	B + 9

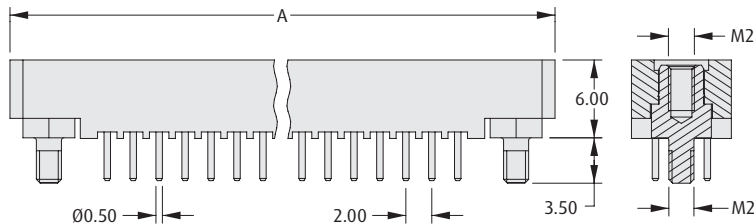
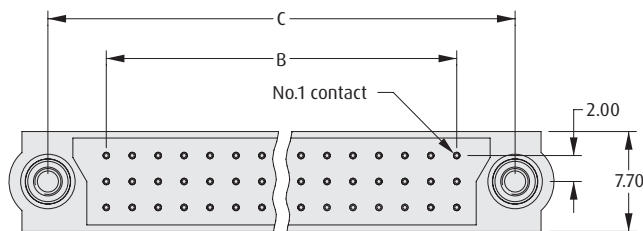

### Board Mount Nut, 2 per connector

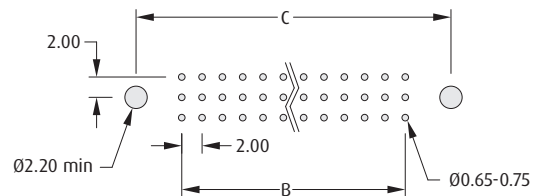
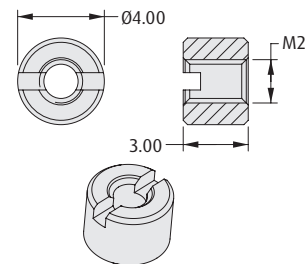

Recommended PC Board Pattern

### HOW TO ORDER

**M83 - LM T1 M2 N XX - 0000 - 000**

<b>SERIES CODE</b>	M83 - LM	<b>TOTAL NO. OF CONTACTS</b>	18, 27, 36, 54, 60, 96
<b>TYPE</b>	T1 3mm Tail	<b>JACKSCREW</b>	M2 Board Mount Jackscrew

All dimensions in mm.