

# Customer Information Sheet

IF IN DOUBT - ASK



NOT TO SCALE

THIRD ANGLE PROJECTION

ALL DIMENSIONS IN mm

TABLE 1: CONFIGURATIONS & BILL OF MATERIALS

ORDER CODE CONFIGURATIONS											BOM ITEM No.								
											1	2	3	4	5	6	7	8	9
G125-XXXXXX69XX-XXXXXX											CONNECTOR 1 (SEE ORDER CODE FOR TOTAL No. OF CONTACTS)	CONNECTOR 1 CONTACT (SEE ORDER CODE FOR QTY.)	CONNECTOR 1 BACKSHELL	BRAID	BAND-IT TIE	PTFE WIRE	CONNECTOR 2 BACKSHELL	CONNECTOR 2 CONTACT (SEE ORDER CODE FOR QTY.)	CONNECTOR 2 (SEE ORDER CODE FOR TOTAL No. OF CONTACTS)
G125	-	FC FD	1 2	06 10 12 16 20 26 34 50	69	F1	-	XXXX	F1	G125-224XX96F1	G125-0010005 G125-0020005	G125-964XXXX	SEE CO49XX	M80-9470000 M80-9480000	SEE C049XX	G125-964XXXX	G125-0010005 G125-0020005		G125-224XX96F1
		MC MD				M1 M3			M1 M3 F1	G125-324XX96M1 G125-324XX96M3	G125-1010005 G125-1020005						G125-1010005 G125-1020005		G125-324XX96M1 G125-324XX96M3 G125-224XX96F1

ORDER CODE:

G125-XXXXXX69XX-XXXXXX

CONNECTOR 1:

F = FEMALE  
M = MALE

WIRING STYLE:

C = STANDARD WIRE  
D = TWISTED PAIR

WIRE GAUGE:

1 = 26AWG  
2 = 28AWG

TOTAL No. OF CONTACTS:

06, 10, 12, 16,  
20, 26, 34, 50

CONNECTOR 2 FIXING STYLE:

F1 = SCREW LOK  
M1 = SCREW LOK  
M3 = SCREW LOK REVERSE FIX

DIM 'A' LENGTH:

0060 = 60mm MIN  
9999 = 9999mm MAX

CONNECTOR 1 FIXING STYLE:

F1 = SCREW LOK  
M1 = SCREW LOK  
M3 = SCREW LOK REVERSE FIX

- NOTES:
- FOR COMPLETE SPECIFICATION, INCLUDING WIRE TYPE AND GAUGE SEE COMPONENT SPECIFICATIONS C125XX & C049XX (LATEST ISSUES).
  - FOR POTTING COMPOUND AND WIRE TYPE SEE C049XX COMPONENT SPECIFICATION.
  - SEE SHEET 7 FOR ASSEMBLIES WITH STANDARD WIRING CONFIGURATIONS.
  - SEE SHEET 8 FOR ASSEMBLIES WITH TWISTED PAIR WIRING CONFIGURATIONS.
  - SEE SHEET 9 FOR HARDWARE FIXING INFORMATION.
  - WIRING OF CONNECTOR:  
CONTACT 1 TO CONTACT 1  
CONTACT 2 TO CONTACT 2, ETC.
  - FOR ALL HOUSING DIMENSIONS, SEE RESPECTIVE DRAWINGS FOR BOM ITEMS 1&9.

HARWIN

www.harwin.com

TOLERANCES  
X. = ±1mm  
X.X = ±0.50mm  
X.XX = ±0.20mm  
X.XXX = ±0.01mm  
ANGLES = ±5°  
UNLESS STATED

THIS DRAWING AND ANY  
INFORMATION OR DESCRIPTIVE  
MATTER SET OUT HEREON ARE  
CONFIDENTIAL AND COPYRIGHT  
PROPERTY OF THE HARWIN GROUP  
AND MUST NOT BE DISCLOSED,  
LOANED, COPIED OR USED FOR  
MANUFACTURING, TENDERING OR FOR  
ANY OTHER PURPOSE WITHOUT THEIR  
WRITTEN PERMISSION.

MATERIAL:  
  
SEE ABOVE

TITLE:  
G125 DOUBLE ENDED SHIELDED  
CABLE ASSEMBLIES - SL

DRAWING NUMBER:  
G125-XXXXXX69XX-XXXXXX

SHT  
6 OF 9

AB	1	24.05.23	32231
NAME	ISS.	DATE	CN/CO
APPROVED: R.PORTLOCK			
CHECKED:		F.CHRISPINE	
DRAWN:		A.BOXALL	
ASSEMBLY DRG:			

Customer Information Sheet

IF IN DOUBT - ASK

C

NOT TO SCALE

THIRD ANGLE PROJECTION

ALL DIMENSIONS IN mm

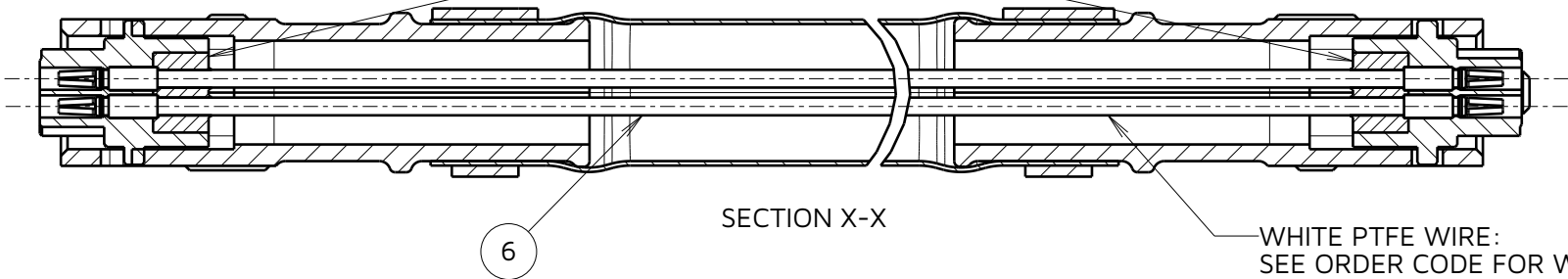
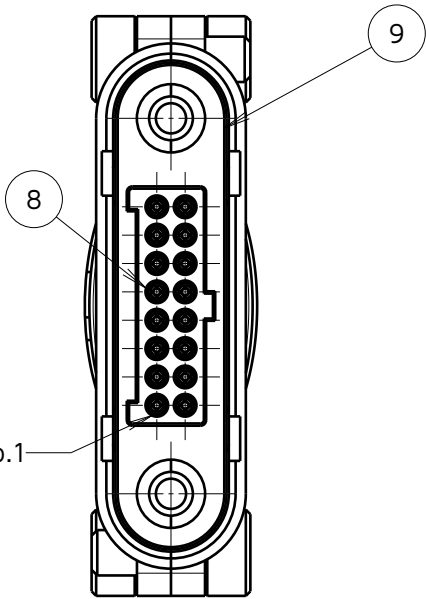
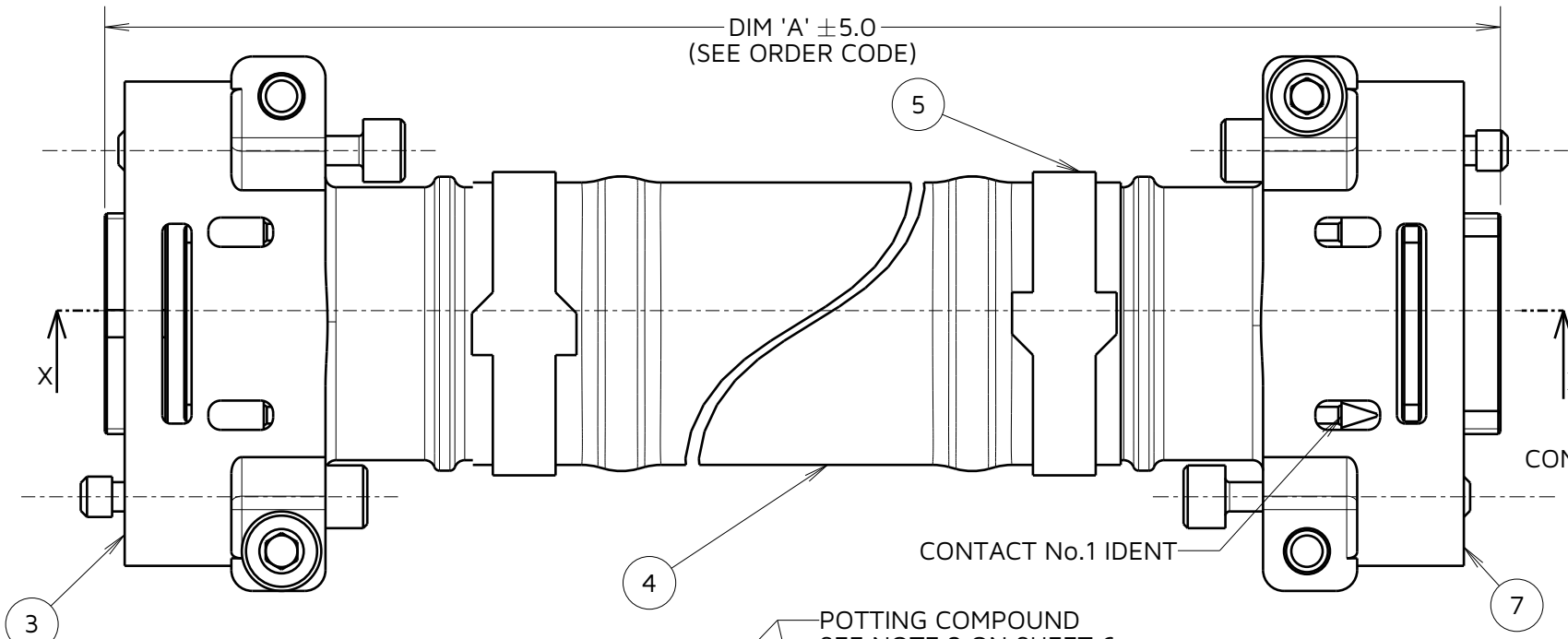
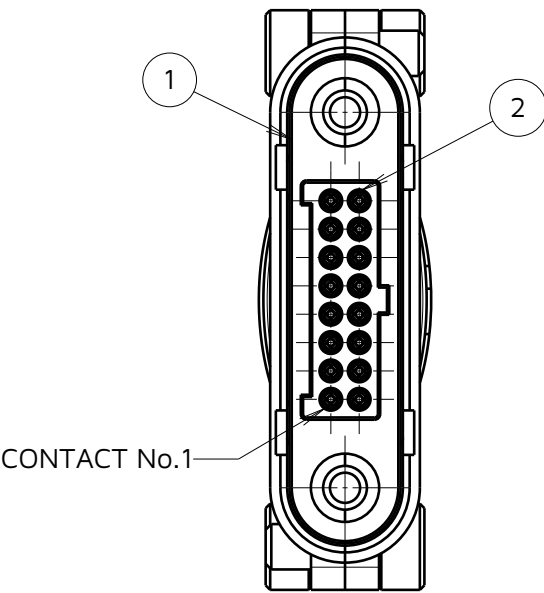

EXAMPLE SHOWN: FEMALE-TO-FEMALE STANDARD WIRING  
G125-FC11669F1-0150F1

ORDER CODE:

G125-XXXXXX69XX-XXXXXX

CONNECTOR 1:  
F = FEMALE  
M = MALE

WIRING STYLE:  
C = STANDARD WIRE  
D = TWISTED PAIR

WIRE GAUGE:  
1 = 26AWG  
2 = 28AWG

TOTAL No. OF CONTACTS:  
06, 10, 12, 16,  
20, 26, 34, 50

CONNECTOR 2 FIXING STYLE:  
F1 = SCREW LOK  
M1 = SCREW LOK  
M3 = SCREW LOK REVERSE FIX

DIM 'A' LENGTH:  
0060 = 60mm MIN  
9999 = 9999mm MAX

CONNECTOR 1 FIXING STYLE:  
F1 = SCREW LOK  
M1 = SCREW LOK  
M3 = SCREW LOK REVERSE FIX

- NOTES:
- 8. POSSIBLE CONFIGURATIONS:  
FEMALE-TO-FEMALE  
MALE-TO-MALE  
MALE-TO-FEMALE
  - 9. FOR POSSIBLE COMBINATIONS, SEE TABLE 1 ON SHEET 6.
  - 10. ASSEMBLY G125-FC11669F1-0150F1 IS SHOWN FOR ILLUSTRATIVE PURPOSES.  
SEE ORDER CODE FOR PART NUMBER.

AB	1	24.05.23	32231
NAME	ISS.	DATE	CN/CO
APPROVED: R.PORTLOCK			
CHECKED: F.CHRISPINE			
DRAWN: A.BOXALL			
ASSEMBLY DRG:			

HARWIN

www.harwin.com

TOLERANCES  
X. =  $\pm 1\text{mm}$   
X.X =  $\pm 0.50\text{mm}$   
X.XX =  $\pm 0.20\text{mm}$   
X.XXX =  $\pm 0.01\text{mm}$   
ANGLES =  $\pm 5^\circ$   
UNLESS STATED

THIS DRAWING AND ANY  
INFORMATION OR DESCRIPTIVE  
MATTER SET OUT HEREON ARE  
CONFIDENTIAL AND COPYRIGHT  
PROPERTY OF THE HARWIN GROUP  
AND MUST NOT BE DISCLOSED,  
LOANED, COPIED OR USED FOR  
MANUFACTURING, TENDERING OR FOR  
ANY OTHER PURPOSE WITHOUT THEIR  
WRITTEN PERMISSION.

MATERIAL:  
  
SEE SHEET 6

TITLE:  
G125 DOUBLE ENDED SHIELDED  
CABLE ASSEMBLIES - SL  
  
DRAWING NUMBER:  
G125-XXXXXX69XX-XXXXXX  
SHT  
7 OF 9

Customer Information Sheet

IF IN DOUBT - ASK

C

NOT TO SCALE

THIRD ANGLE PROJECTION

ALL DIMENSIONS IN mm

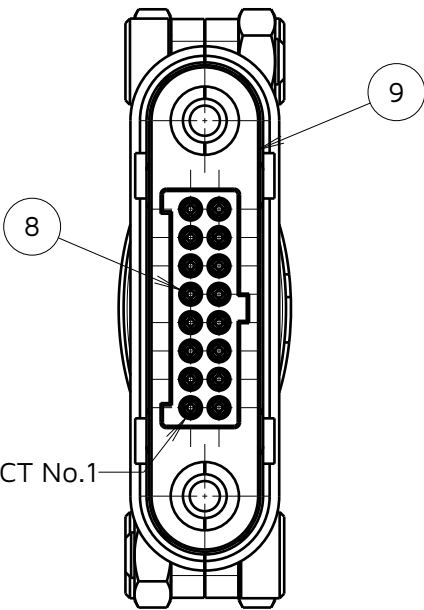
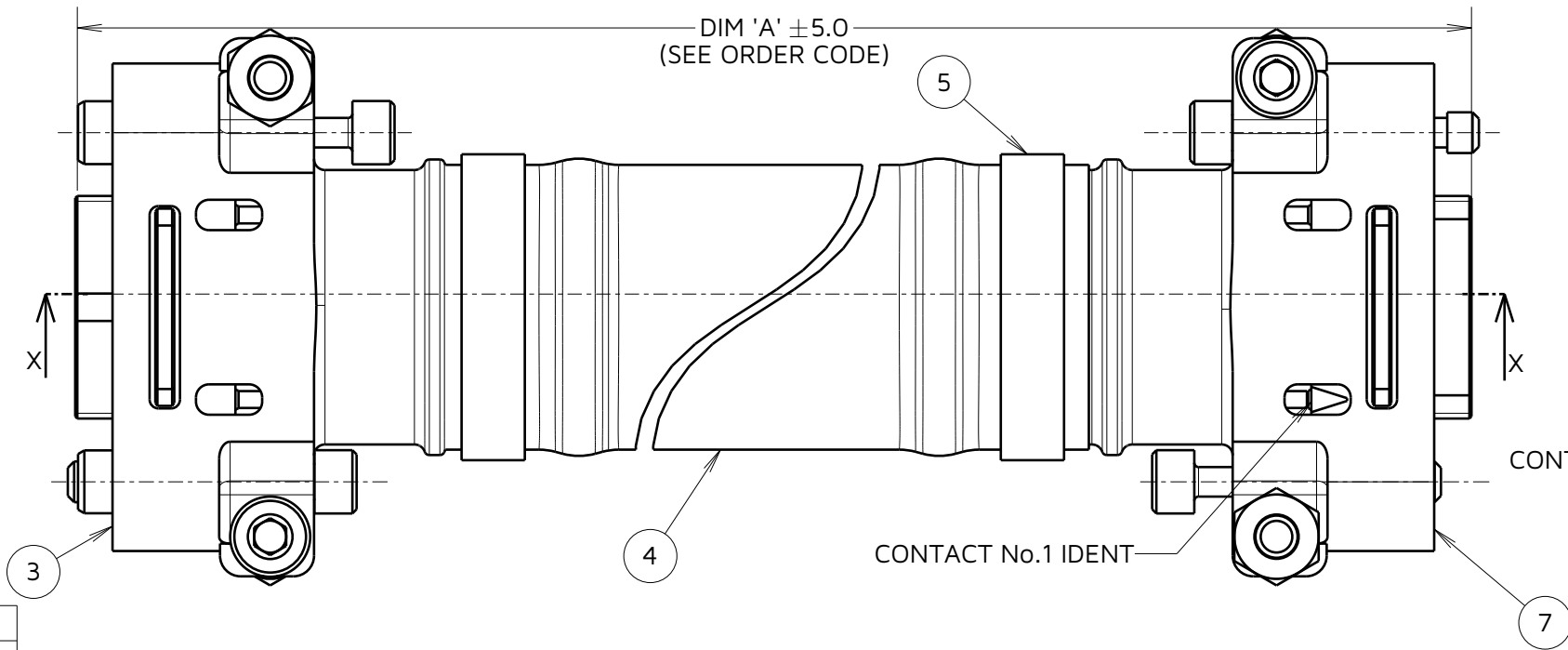
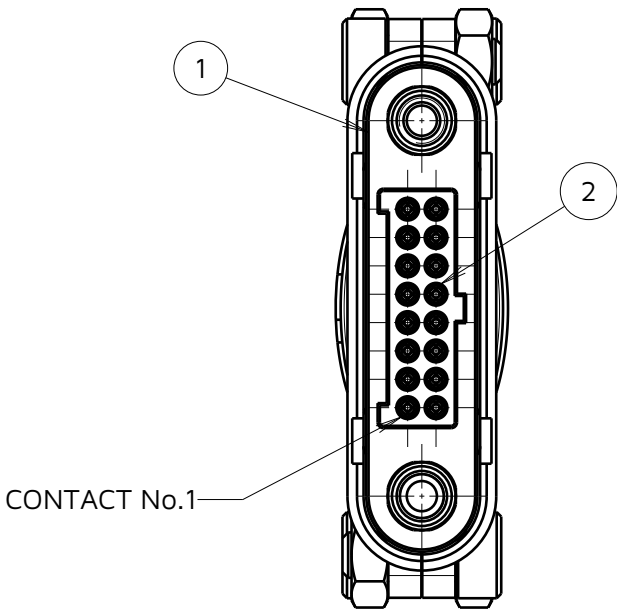
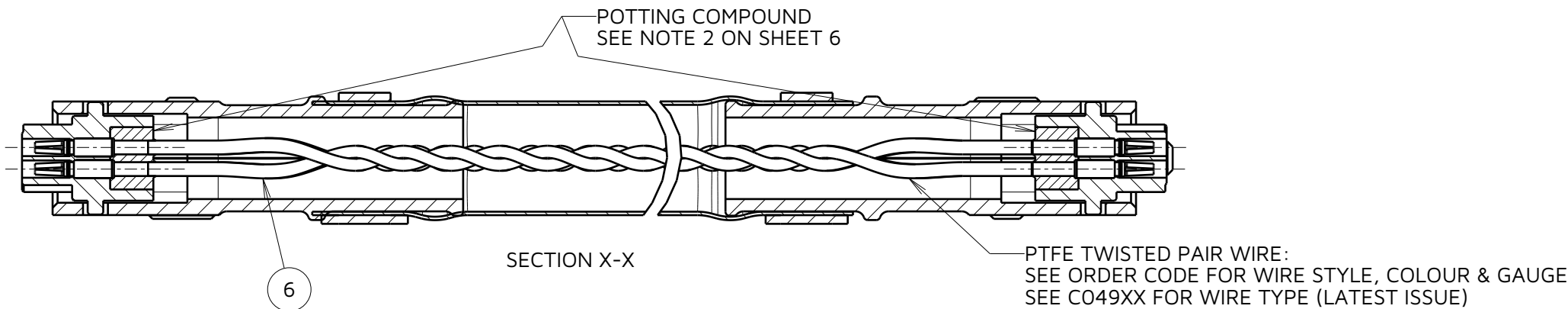

TABLE 2: TWISTED PAIR CABLE CONFIGURATIONS			
WIRING FOR EXAMPLE PART No. G125-FD11669F1-0150F1			
TWISTED PAIR No.	CONNECTOR PIN No.	TURNS PER INCH	WIRE COLOUR
1	1	3	WHITE & GREEN
	9		
2	2	2	WHITE & RED
	10		
3	3	3	WHITE & GREEN
	11		
4	4	2	WHITE & RED
	12		
5	5	3	WHITE & GREEN
	13		
6	6	2	WHITE & RED
	14		
7	7	3	WHITE & GREEN
	15		
8	8	2	WHITE & RED
	16		
FOR CONNECTORS WITH MORE THAN 16 CONTACTS, CONTINUE TWIST & CABLE PIN OUT CONVENTION IN THE SAME PATTERN. (I.E. TWISTED PAIR BETWEEN CONTACT X & CONTACT X)			
SEE BILL OF MATERIALS TABLE ON SHEET 6 FOR TWISTED PAIR PART NUMBERS.			



ORDER CODE:

G125-XXXXX69XX-XXXXXX

CONNECTOR 1:  
F = FEMALE  
M = MALE

WIRING STYLE:  
C = STANDARD WIRE  
D = TWISTED PAIR

WIRE GAUGE:  
1 = 26AWG  
2 = 28AWG

TOTAL No. OF CONTACTS:  
06, 10, 12, 16,  
20, 26, 34, 50

CONNECTOR 2 FIXING STYLE:  
F1 = SCREW LOK  
M1 = SCREW LOK  
M3 = SCREW LOK REVERSE FIX

DIM 'A' LENGTH:  
0060 = 60mm MIN  
9999 = 9999mm MAX

CONNECTOR 1 FIXING STYLE:  
F1 = SCREW LOK  
M1 = SCREW LOK  
M3 = SCREW LOK REVERSE FIX

EXAMPLE SHOWN: FEMALE-TO-FEMALE TWISTED PAIRS  
G125-FD11669F1-0150F1

- NOTES:
- 11. POSSIBLE CONFIGURATIONS:
    - FEMALE-TO-FEMALE
    - MALE-TO-MALE
    - MALE-TO-FEMALE
  - 12. FOR POSSIBLE COMBINATIONS, SEE TABLE 1 ON SHEET 6.
  - 13. ASSEMBLY G125-FD11669F1-0150F1 IS SHOWN FOR ILLUSTRATIVE PURPOSES. SEE ORDER CODE FOR PART NUMBER.

AB	1	24.05.23	32231
NAME	ISS.	DATE	CN/CO
APPROVED: R.PORTLOCK			
CHECKED: F.CHRISPINE			
DRAWN: A.BOXALL			
ASSEMBLY DRG:			

HARWIN

www.harwin.com

TOLERANCES  
X. = ±1mm  
X.X = ±0.50mm  
X.XX = ±0.20mm  
X.XXX = ±0.01mm  
ANGLES = ±5°  
UNLESS STATED

THIS DRAWING AND ANY INFORMATION OR DESCRIPTIVE MATTER SET OUT HEREON ARE CONFIDENTIAL AND COPYRIGHT PROPERTY OF THE HARWIN GROUP AND MUST NOT BE DISCLOSED, LOANED, COPIED OR USED FOR MANUFACTURING, TENDERING OR FOR ANY OTHER PURPOSE WITHOUT THEIR WRITTEN PERMISSION.

MATERIAL:  
  
SEE SHEET 6

TITLE:  
G125 DOUBLE ENDED SHIELDED  
CABLE ASSEMBLIES - SL

DRAWING NUMBER:  
G125-XXXXX69XX-XXXXXX

SHT  
8 OF 9

# Customer Information Sheet

IF IN DOUBT - ASK

©

NOT TO SCALE

THIRD ANGLE PROJECTION

ALL DIMENSIONS IN mm

## FIXING STYLE IDENTIFICATION

FEMALE

F1

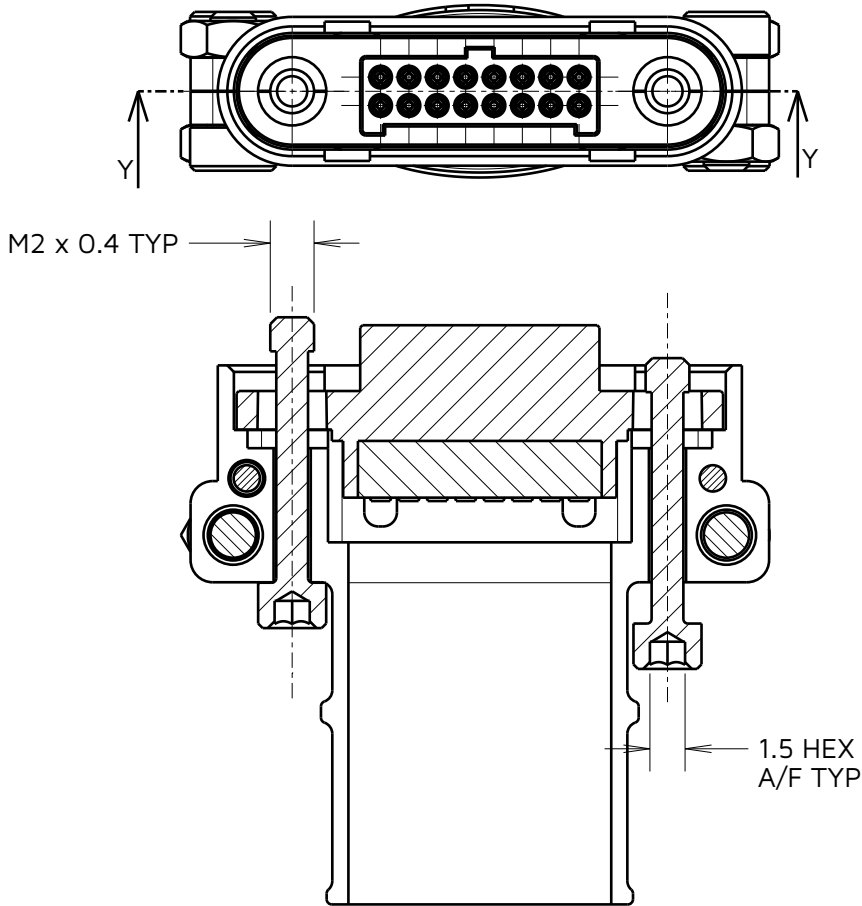

SECTION Y-Y

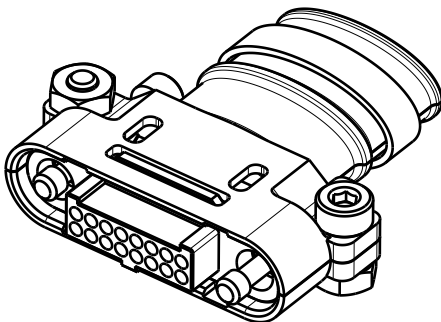

M1

M2 x 0.4 TYP

SECTION Y-Y

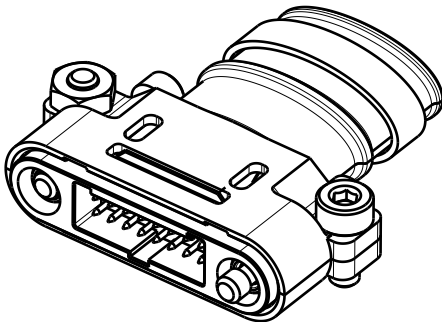

M3

M2 x 0.4 TYP

SECTION Y-Y

1.5 HEX  
A/F TYP

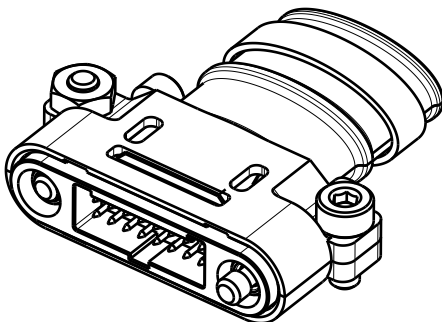

MALE

ORDER CODE:

G125-XXXXX69XX-XXXXXX

CONNECTOR 1:

F = FEMALE  
M = MALE

WIRING STYLE:

C = STANDARD WIRE  
D = TWISTED PAIR

WIRE GAUGE:

1 = 26AWG  
2 = 28AWG

TOTAL No. OF CONTACTS:

06, 10, 12, 16,  
20, 26, 34, 50

CONNECTOR 2 FIXING STYLE:

F1 = SCREW LOK  
M1 = SCREW LOK  
M3 = SCREW LOK REVERSE FIX

DIM 'A' LENGTH:

0060 = 60mm MIN  
9999 = 9999mm MAX

CONNECTOR 1 FIXING STYLE:

F1 = SCREW LOK  
M1 = SCREW LOK  
M3 = SCREW LOK REVERSE FIX

NOTES:  
14: SEE BILL OF MATERIALS TABLE ON SHEET 6 AND ORDER CODE FOR FIXING IDENTIFICATION.

HARWIN

www.harwin.com

TOLERANCES

X. =  $\pm 1\text{mm}$   
X.X =  $\pm 0.50\text{mm}$   
X.XX =  $\pm 0.20\text{mm}$   
X.XXX =  $\pm 0.01\text{mm}$

ANGLES =  $\pm 5^\circ$   
UNLESS STATED

THIS DRAWING AND ANY INFORMATION OR DESCRIPTIVE MATTER SET OUT HEREON ARE CONFIDENTIAL AND COPYRIGHT PROPERTY OF THE HARWIN GROUP AND MUST NOT BE DISCLOSED, LOANED, COPIED OR USED FOR MANUFACTURING, TENDERING OR FOR ANY OTHER PURPOSE WITHOUT THEIR WRITTEN PERMISSION.

MATERIAL:

SEE SHEET 6

TITLE:

G125 DOUBLE ENDED SHIELDED  
CABLE ASSEMBLIES - SL

DRAWING NUMBER:

G125-XXXXX69XX-XXXXXX

SHT  
9  
OF  
9

AB	1	24.05.23	32231
NAME	ISS.	DATE	CN/CO
APPROVED: R.PORTLOCK			
CHECKED: F.CHRISPINE			
DRAWN: A.BOXALL			
ASSEMBLY DRG:			